



# SIoux CITY PUBLIC MUSEUM

**Museum Hours:**  
Tuesday – Saturday  
10:00 a.m. – 5:00 p.m.  
Sunday 1:00 – 5:00 p.m.

**Admission is free, but donations are appreciated.** A “donation cow” is located in the lobby. Membership and endowment giving forms are available at the information desk or at [SiouxCityMuseum.org](http://SiouxCityMuseum.org).

**Research Center Hours:**  
Tuesday – Friday  
10:00 a.m. – 5:00 p.m.  
Monday & Saturday by appointment (224-5001).  
Use Jackson St. entrance.

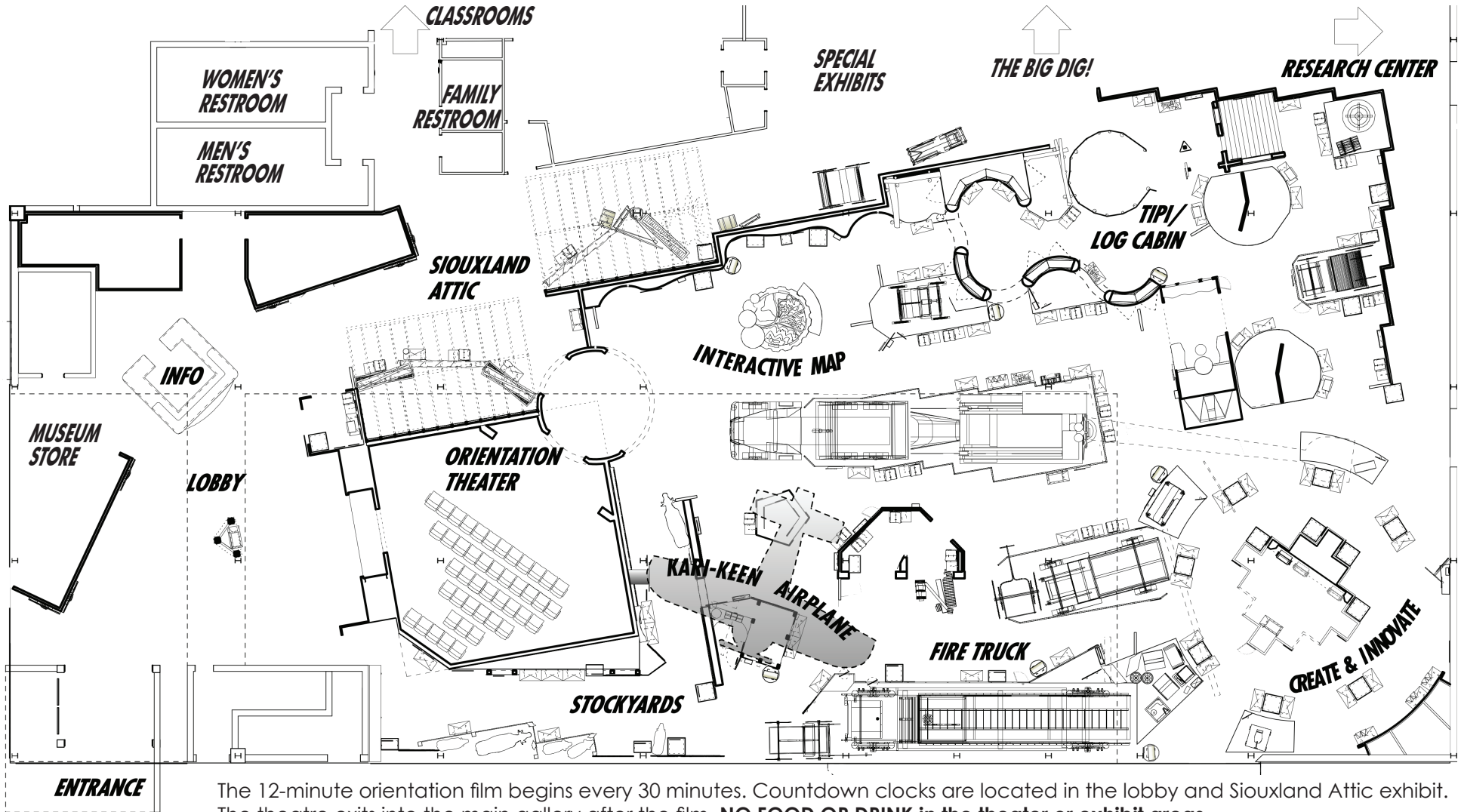

The 12-minute orientation film begins every 30 minutes. Countdown clocks are located in the lobby and Siouxland Attic exhibit. The theatre exits into the main gallery after the film. **NO FOOD OR DRINK in the theater or exhibit areas.**

Every 10 minutes siren lights and an announcement signal the beginning of one of three Sioux City disaster presentations next to the fire truck.

A limited number of wheelchairs are available upon request on a first come, first served basis. Headphones for the orientation film are available for the hearing impaired at the information desk.